

# Shipping Condition

To reset the unit back to default settings as it left the factory, use Shipping Condition. All of the TV stations will be retuned and all other settings changed by the user will be reset.

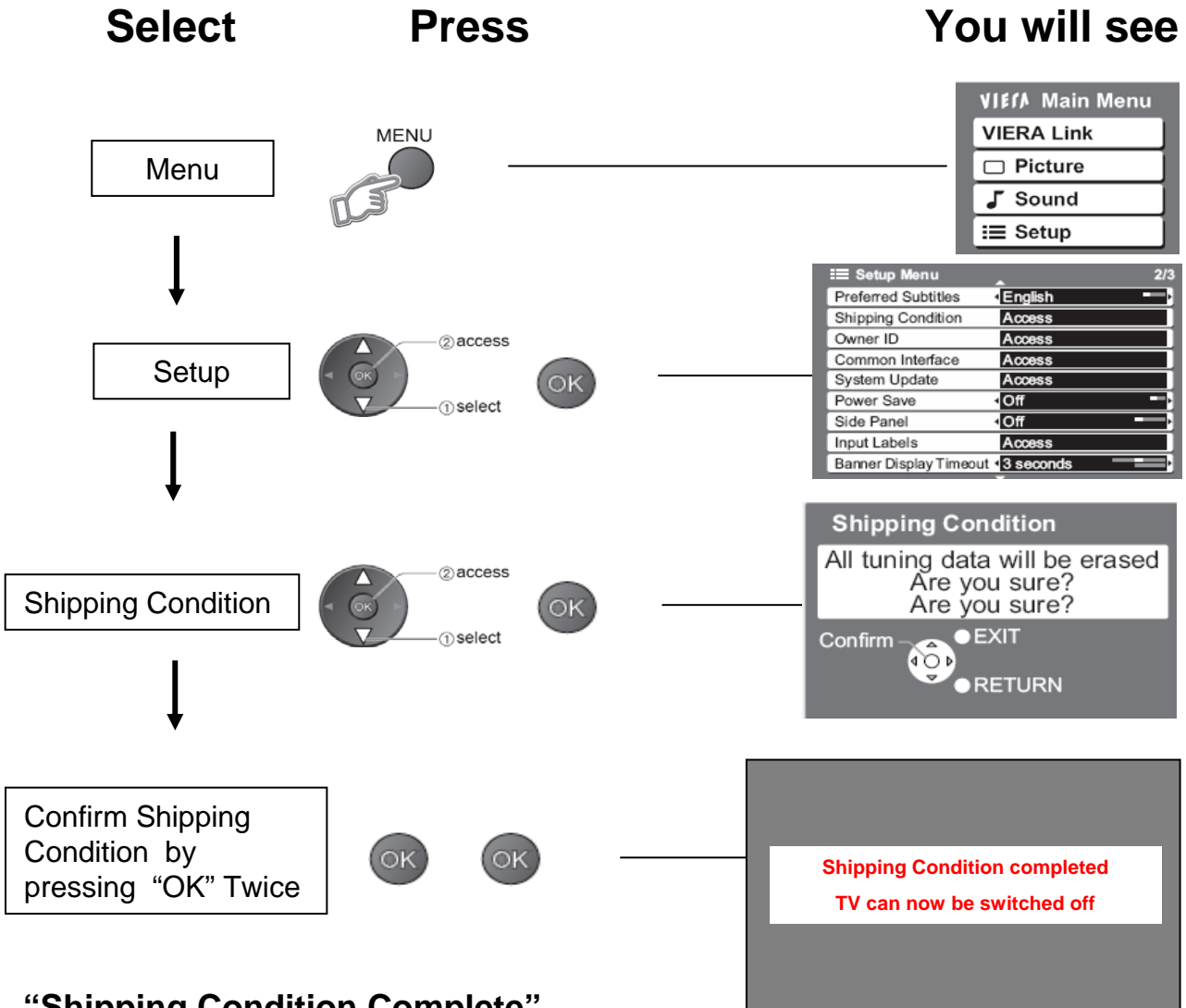

## “Shipping Condition Complete”

After a few seconds the TV will be set to Shipping Condition and you will be prompted to switch off the unit. Leave the unit for at least five seconds before switching back on.

**Auto setup will start when the TV is next switched on**